

Label	Qty	Symbol	Manufacturer	Description	LLF	Arr. Watts	Arr. Lum. Lumens	Height	Filename	Arr.	Test
R-12-HS	13	—	SIGNIFY	RPM150x60, E44-G2-R3M-HS	0.90	145	19318	35	RPM150x60, E44-G2-R3M-HS.txd	8	0
R-13-HS	1	—	SIGNIFY	RPM150x60, E44-G2-R3M-HS	0.90	149	19338	35	RPM150x60, E44-G2-R3M-HS.txd	8	0

Calculation Values - 08 Lighting Consultation	CalcType	Units	Avg	Max	Min	Avg/Min	Max/Min
Access Road In, Illum	Illuminance	Fc	1.68	3.7	0.7	2.4	5.39
Access Road In, Lumens	Luminaire	CD/Sqm	1.77	3.9	0.8	1.77	3.38
Access Road In, Vel. Lum	Velocity Luminaire	CD/Sqm	0.11	0.4	NA	NA	NA
Access Road Out, Illum	Illuminance	Fc	1.41	2.7	0.6	1.57	3.00
Access Road Out, Lumens	Luminaire	CD/Sqm	0.98	2.7	0.9	1.96	3.48
Access Road Out, Vel. Lum	Velocity Luminaire	CD/Sqm	0.11	0.3	NA	NA	NA
Additional Roadway	Illuminance	Fc	1.53	3.3	0.9	2.14	4.60
Entry Roadway	Illuminance	Fc	0.53	1.0	0.1	5.30	10.00

Label	Qty	Symbol	Manufacturer	Description	LLF	Arr. Watts	Arr. Lum. Lumens	Height	Filename	Arr.	Test
C-15	30	—	SIGNIFY	GC-C-48-100-NV-G2	0.90	1034	11450	16	GC-C-48-100-NV-G2.txd	0	0
P-13-HS	24	—	PHILIPS	PHS180-1050-NV-G2-HS	0.90	102.60	11077	25.30	PHS180-1050-NV-G2-HS.txd	12	0
P-14	31	—	PHILIPS	PHS180-1050-NV-G2-4	0.90	414.9033	47604	40	PHS180-1050-NV-G2-4.txd	12	0
P-14-HS	14	—	PHILIPS	PHS180-1050-NV-G2-HS	0.90	414.9033	47604	25.40	PHS180-1050-NV-G2-HS.txd	12	0
P-15	26	—	PHILIPS	PHS180-1050-NV-G2-3W	0.90	414.9033	48790	25.30	PHS180-1050-NV-G2-3W.txd	12	0
P-15-HS	11	—	PHILIPS	PHS180-1050-NV-G2-3W	0.90	414.9033	47604	25.40	PHS180-1050-NV-G2-3W.txd	12	0
V-14	4	—	SIGNIFY	F30-48-400-NV-G2-4	0.90	6257.94	6887	18	F30-48-400-NV-G2-4.txd	1	0
V-14-HS	18	—	SIGNIFY	F30-48-400-NV-G2-4	0.90	74.3573	10790	18	F30-48-400-NV-G2-4.txd	1	0

Calculation Values - 08 Lighting Consultation	CalcType	Units	Avg	Max	Min	Avg/Min	Max/Min
Church Parking Lot	Illuminance	Fc	4.48	10.7	1.7	2.64	6.29
Fuel Pumps Court	Illuminance	Fc	2.88	5.4	1.2	2.50	4.00
Fuel Pumps Drive	Illuminance	Fc	32.36	57.7	13.4	2.40	4.31
Feeding and Weigh Station	Illuminance	Fc	3.09	10.3	1.7	2.94	6.65
Internal Access Roads	Illuminance	Fc	3.50	7.7	1.0	3.50	7.70
Maintenance Lot	Illuminance	Fc	3.78	8.2	1.2	2.98	7.67
Property Line North Side	Illuminance	Fc	0.57	0.3	0.3	NA	NA
Trailer Parking	Illuminance	Fc	2.58	5.6	1.0	2.58	5.60
Warehouse Back Area	Illuminance	Fc	5.44	14.1	1.9	2.86	7.42



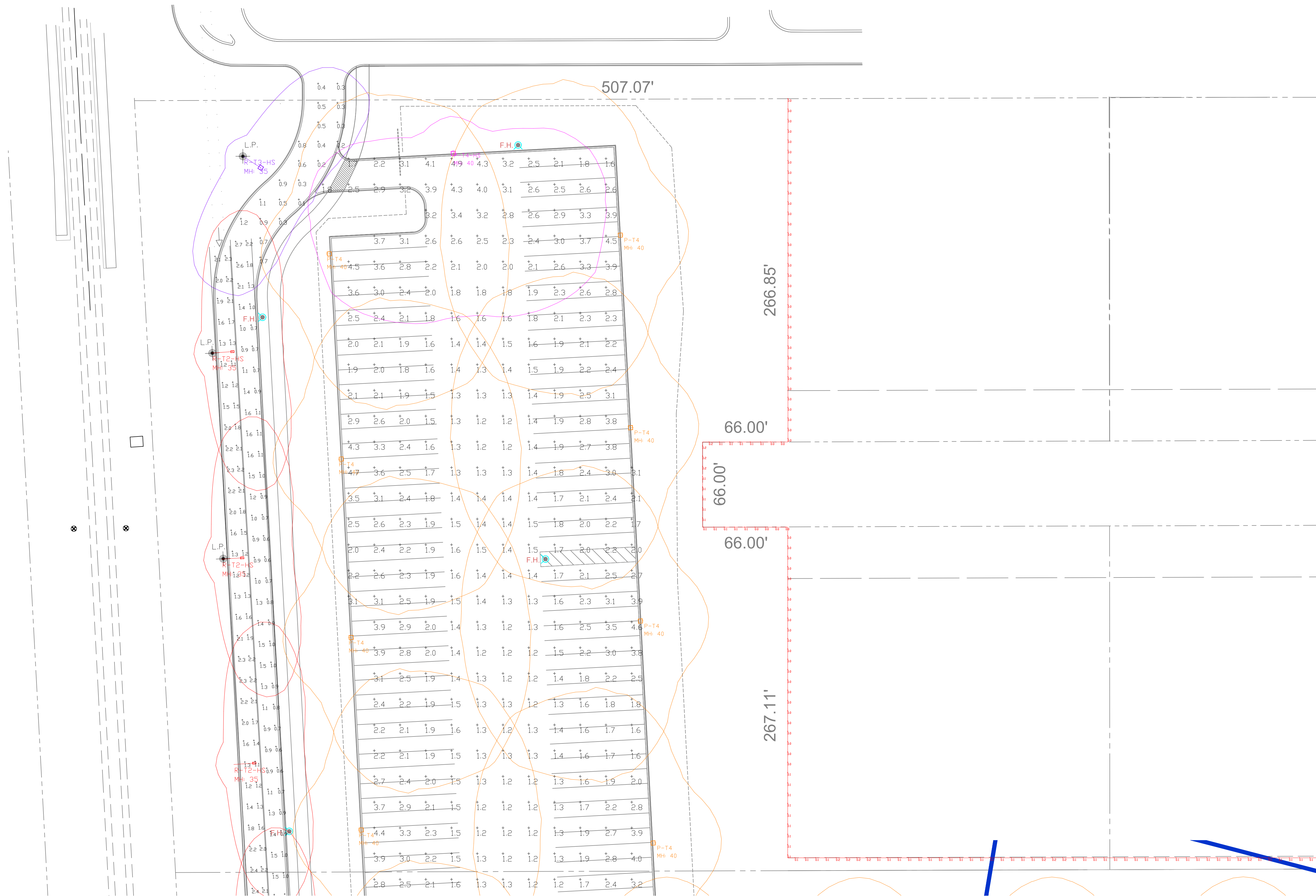
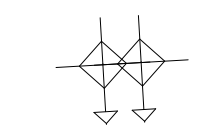

ELECTRICAL SITE LIGHTING PLAN

SCALE: 1" = 40'-0"

0' 40' 80'

NORTH

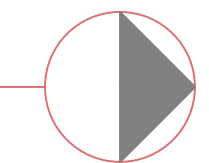

ELECTRICAL SITE LIGHTING PLAN

EXPERIOR LOGISTICS FACILITY
1001 West Irving Park Road
SCHAUMBURG, IL

FOR

EXPERIOR TRANSPORT
12161 SOUTH CENTRAL AVE.
ALSIP, IL 60803



E2.0

PROJECT #: 18010
DATE: 06/11/18
REVISIONS: 01/17/22
SCALE: AS NOTED

©COPYRIGHT 2022
arete design studio, ltd
ALL RIGHTS RESERVED

**ELECTRICAL
 SITE
 LIGHTING
 PLAN**

**EXPERIOR
 LOGISTICS
 FACILITY**
 1001 West Irving Park Road
 SCHAUMBURG, IL

FOR

**EXPERIOR
 TRANSPORT**
 12161 SOUTH CENTRAL AVE.
 ALSIP, IL 60803



E3.0

PROJECT #: 18010
 DATE: 06/11/18
 REVISIONS: 01/17/22
 SCALE: AS NOTED

©COPYRIGHT 2022
 arete design studio, ltd
 ALL RIGHTS RESERVED

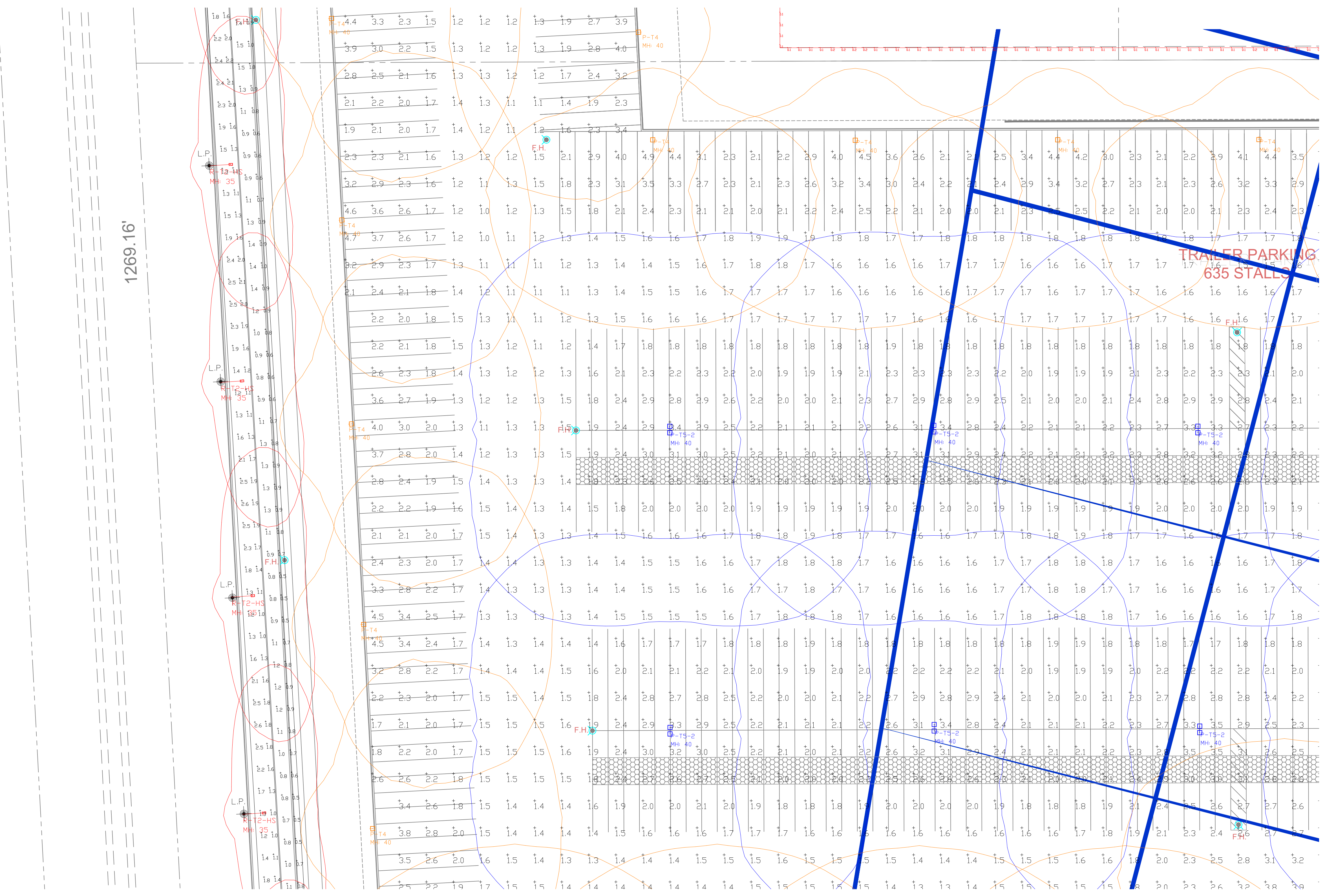

ELECTRICAL SITE LIGHTING PLAN
 SCALE: 1" = 40'-0"
 NORTH
 0' 40' 80'

CIVIL ENGINEER:



LANDSCAPE ARCHITECT:



WETLAND CONSULTANT:



GARY R. WEBER
ASSOCIATES, INC.
 LAND PLANNING
 ECOLOGICAL CONSULTING
 LANDSCAPE ARCHITECTURE
 402 W. LIBERTY DRIVE
 WHEATON, ILLINOIS 60187
 PH: 630-668-7197

ELECTRICAL
SITE
LIGHTING
PLAN

EXPERIOR
LOGISTICS
FACILITY

1001 West Irving Park Road
SCHAUMBURG, IL

FOR

EXPERIOR
TRANSPORT

12161 SOUTH CENTRAL AVE.
ALSIP, IL 60803



E4.0

PROJECT #: 18010
 DATE: 06/11/18
 REVISIONS: 01/17/22
 SCALE: AS NOTED

©COPYRIGHT 2022
 arete design studio, inc.
 ALL RIGHTS RESERVED

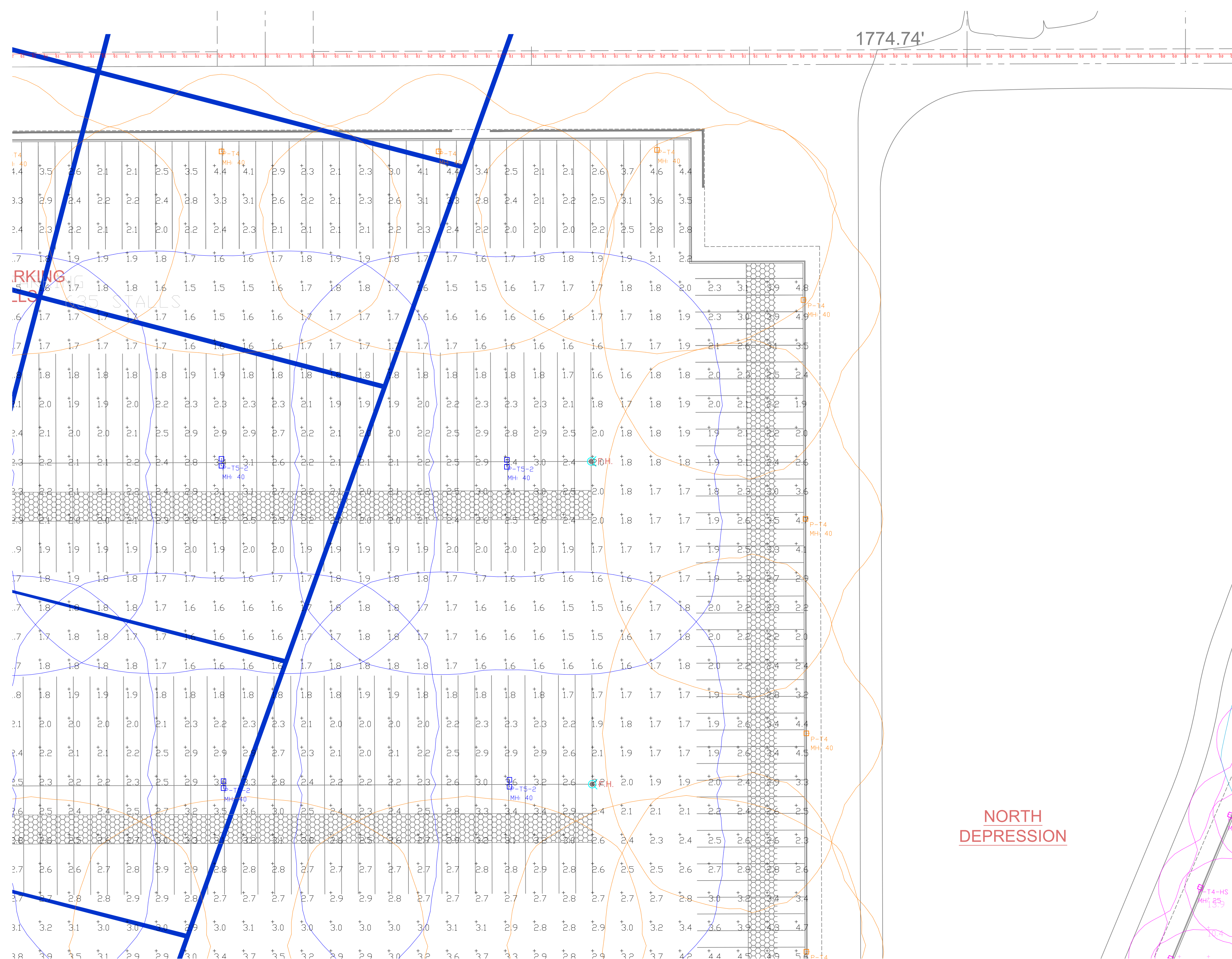

ELECTRICAL SITE LIGHTING PLAN

SCALE: 1" = 40'-0"



CIVIL ENGINEER:



900 WOODLANDS PARKWAY
 VERNON HILLS, IL 60061

LANDSCAPE ARCHITECT:



WETLAND CONSULTANT:



GARY R. WEBER
 ASSOCIATES, INC.

LAND PLANNING
 ECOLOGICAL CONSULTING
 LANDSCAPE ARCHITECTURE

402 W. LIBERTY DRIVE
 WHEATON, ILLINOIS 60187
 PH: 630-668-7197

ELECTRICAL
 SITE
 LIGHTING
 PLAN

EXPERIOR
 LOGISTICS
 FACILITY

1001 West Irving Park Road
 SCHAUMBURG, IL

FOR

EXPERIOR
 TRANSPORT

12161 SOUTH CENTRAL AVE.
 ALSIP, IL 60803



E5.0

PROJECT #: 18010
 DATE: 06/11/18
 REVISIONS: 01/17/22
 SCALE: AS NOTED

©COPYRIGHT 2022
 arete design studio, ltd
 ALL RIGHTS RESERVED

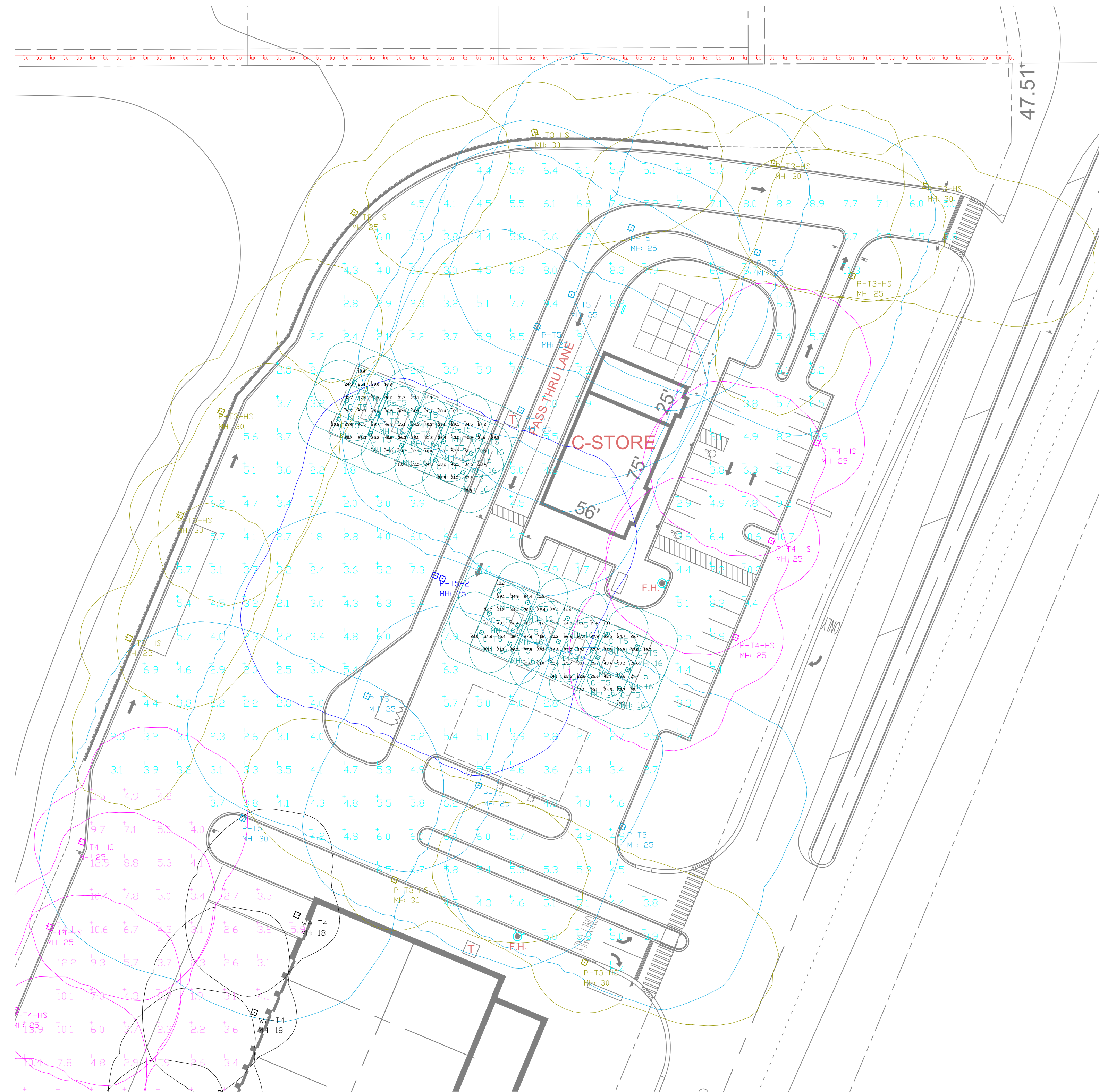

ELECTRICAL SITE LIGHTING PLAN

SCALE: 1" = 40'-0"



NORTH

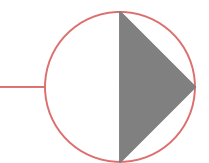

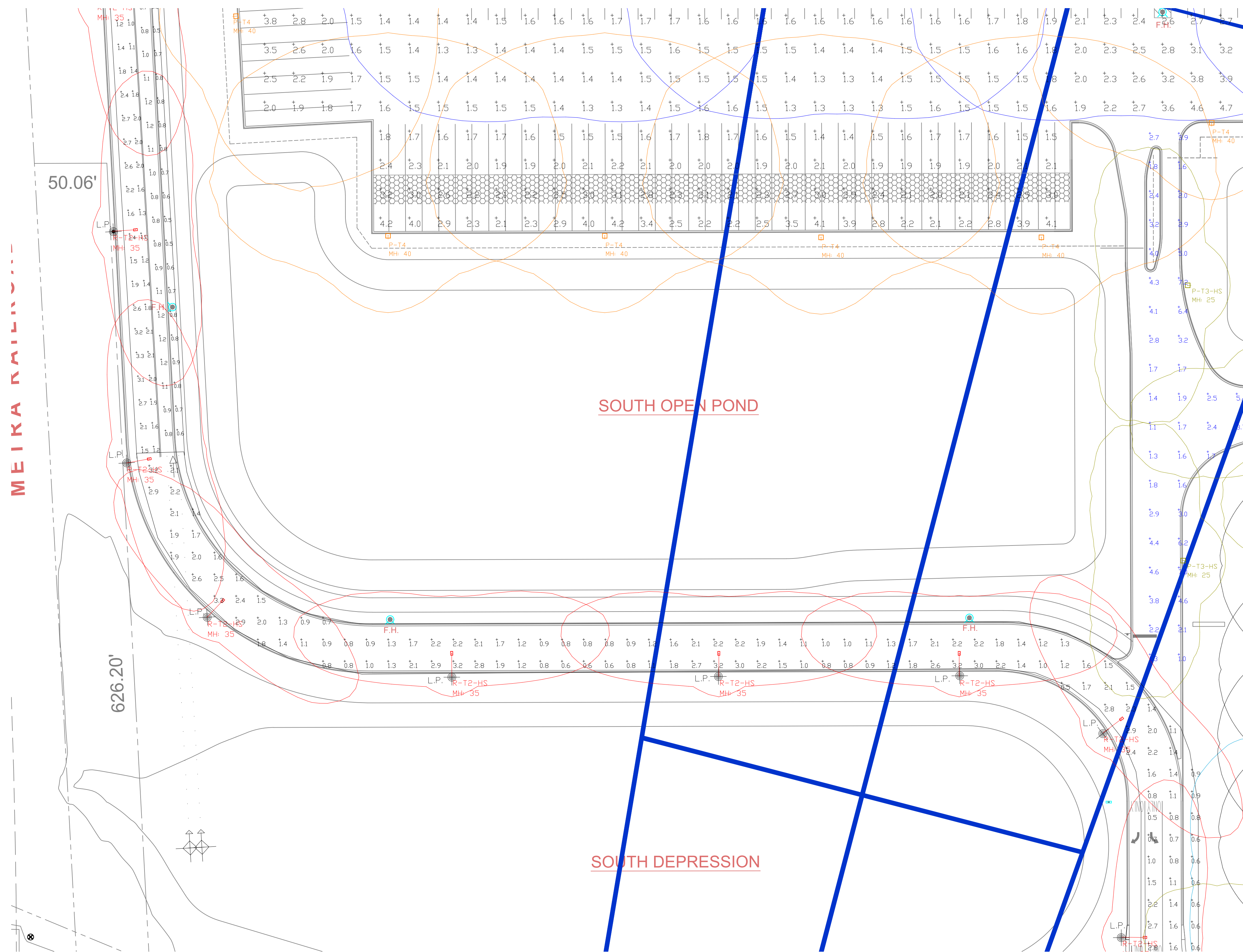

ELECTRICAL SITE LIGHTING PLAN

SCALE: 1" = 40'-0"



NORTH

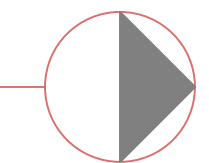

CIVIL ENGINEER:



900 WOODLANDS PARKWAY
VERNON HILLS, IL 60061

LANDSCAPE ARCHITECT:



1250 W 18th St, Chicago, Illinois 60608
2642 Lockport St, Plainfield, Illinois 60544
815-254-0091 www.uplanddesign.com

WETLAND CONSULTANT:



GARY R. WEBER
ASSOCIATES, INC.

LAND PLANNING
ECOLOGICAL CONSULTING
LANDSCAPE ARCHITECTURE

402 W. LIBERTY DRIVE
WHEATON, ILLINOIS 60187
PH: 630-668-7197

ELECTRICAL SITE LIGHTING PLAN

EXPERIOR LOGISTICS FACILITY

1001 West Irving Park Road
SCHAUMBURG, IL

FOR

EXPERIOR TRANSPORT

12161 SOUTH CENTRAL AVE.
ALSIP, IL 60803



E6.0

PROJECT #: 18010
DATE: 06/11/18
REVISIONS: 01/17/22
SCALE: AS NOTED

©COPYRIGHT 2022
arete design studio, ltd
ALL RIGHTS RESERVED

CIVIL ENGINEER:



900 WOODLANDS PARKWAY
 VERNON HILLS, IL 60061

LANDSCAPE ARCHITECT:



WETLAND CONSULTANT:



GARY R. WEBER
 ASSOCIATES, INC.
 LAND PLANNING
 ECOLOGICAL CONSULTING
 LANDSCAPE ARCHITECTURE
 402 W. LIBERTY DRIVE
 WHEATON, ILLINOIS 60187
 PH: 630-668-7197

ELECTRICAL
 SITE
 LIGHTING
 PLAN

EXPERIOR
 LOGISTICS
 FACILITY

1001 West Irving Park Road
 SCHAUMBURG, IL

FOR

EXPERIOR
 TRANSPORT

12161 SOUTH CENTRAL AVE.
 ALSIP, IL 60803



E7.0

PROJECT #: 18010
 DATE: 06/11/18
 REVISIONS: 01/17/22
 SCALE: AS NOTED

©COPYRIGHT 2022
 arete design studio, ltd
 ALL RIGHTS RESERVED

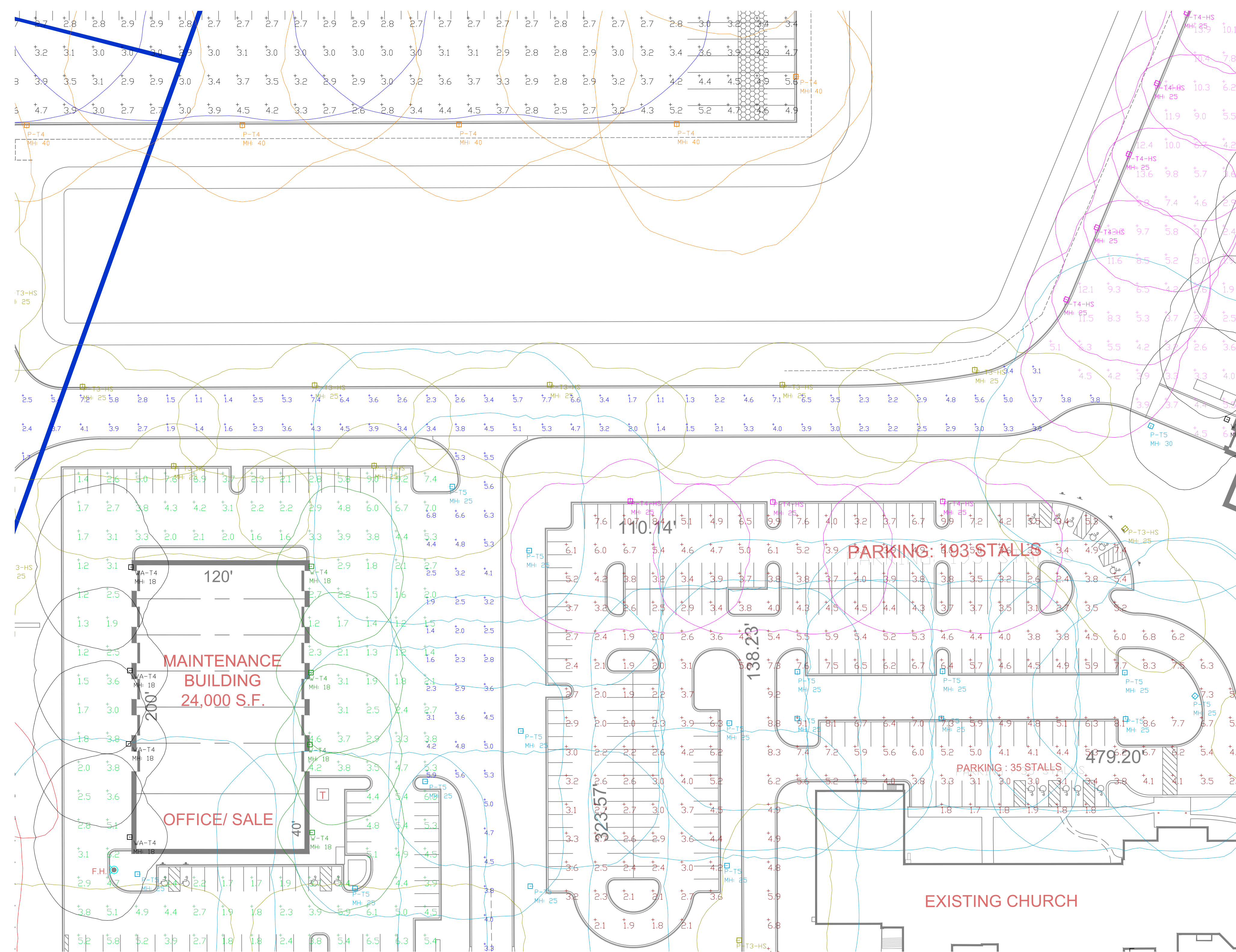

ELECTRICAL SITE LIGHTING PLAN

SCALE: 1" = 40'-0"



NORTH

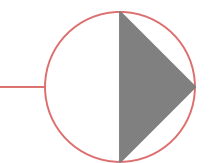

CIVIL ENGINEER:



900 WOODLANDS PARKWAY
 VERNON HILLS, IL 60061

LANDSCAPE ARCHITECT:



WETLAND CONSULTANT:



GARY R. WEBER
 ASSOCIATES, INC.

LAND PLANNING
 ECOLOGICAL CONSULTING
 LANDSCAPE ARCHITECTURE

402 W. LIBERTY DRIVE
 WHEATON, ILLINOIS 60187
 PH: 630-668-7197

ELECTRICAL
 SITE
 LIGHTING
 PLAN

EXPERIOR
 LOGISTICS
 FACILITY

1001 West Irving Park Road
 SCHAUMBURG, IL

FOR

EXPERIOR
 TRANSPORT

12161 SOUTH CENTRAL AVE.
 ALSIP, IL 60803



E8.0

PROJECT #: 18010
 DATE: 06/11/18
 REVISIONS: 01/17/22
 SCALE: AS NOTED

©COPYRIGHT 2022
 arete design studio, ltd
 ALL RIGHTS RESERVED

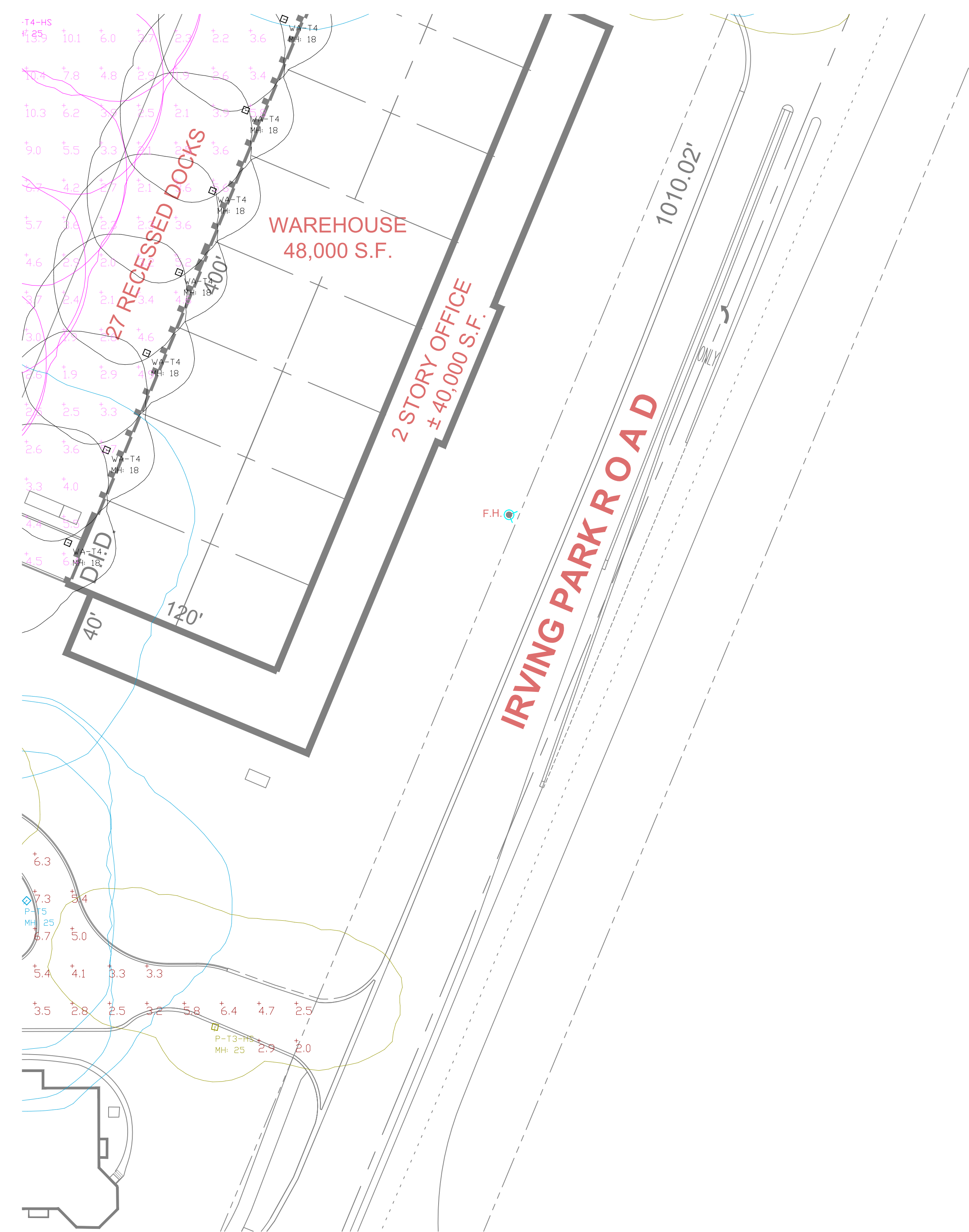

ELECTRICAL SITE LIGHTING PLAN

SCALE: 1" = 40'-0"

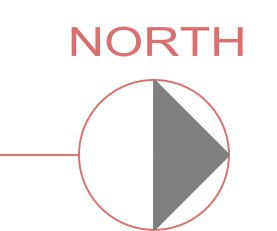

CIVIL ENGINEER:



900 WOODLANDS PARKWAY
 VERNON HILLS, IL 60061

LANDSCAPE ARCHITECT:



WETLAND CONSULTANT:



GARY R. WEBER
 ASSOCIATES, INC.
 LAND PLANNING
 ECOLOGICAL CONSULTING
 LANDSCAPE ARCHITECTURE
 402 W. LIBERTY DRIVE
 WHEATON, ILLINOIS 60187
 PH: 630-668-7197

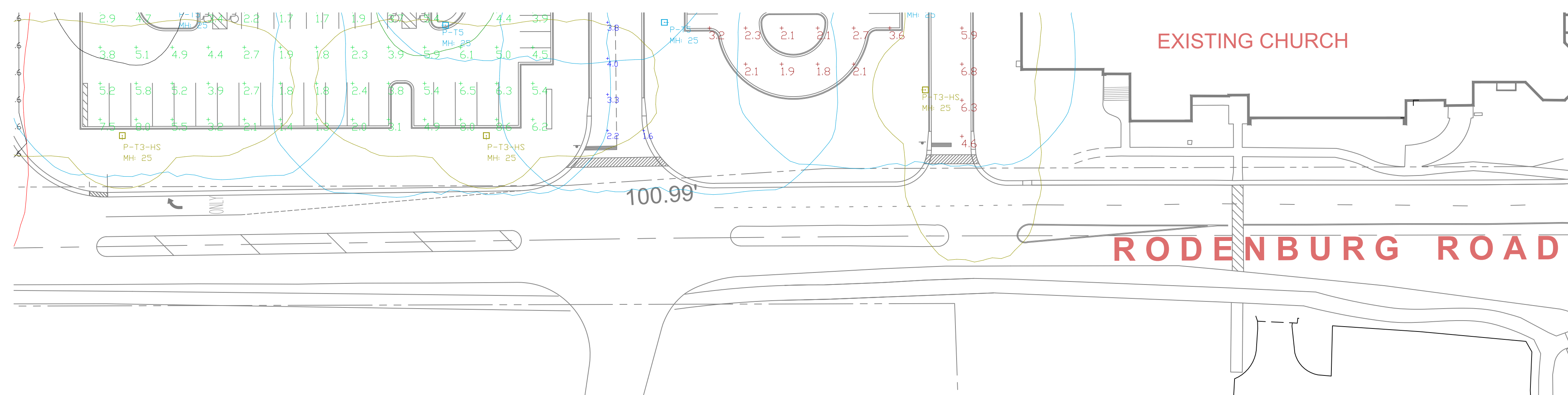

ELECTRICAL SITE LIGHTING PLAN

SCALE: 1" = 40'-0"

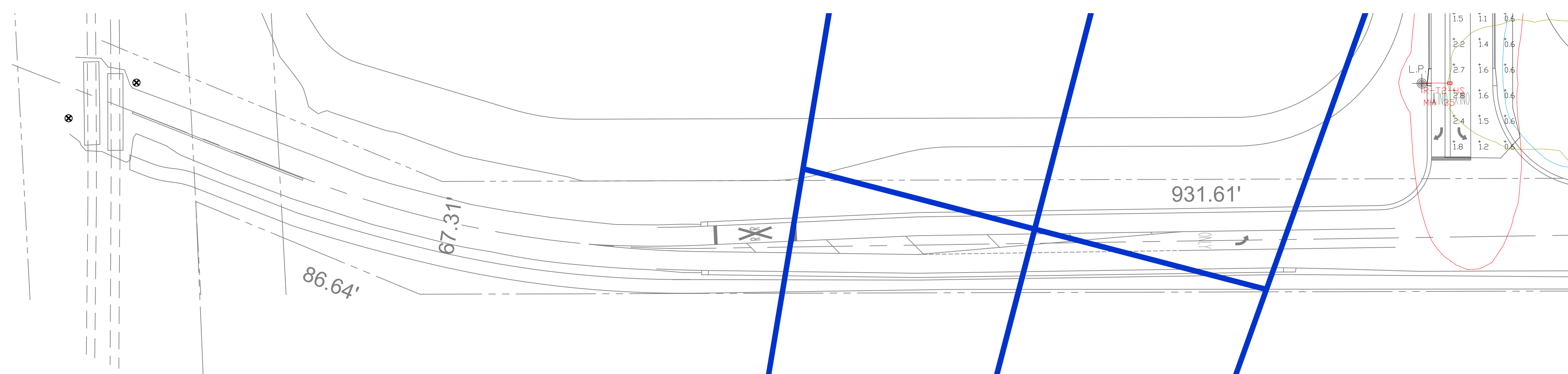

ELECTRICAL SITE LIGHTING PLAN

SCALE: 1" = 40'-0"



ELECTRICAL
 SITE
 LIGHTING
 PLAN

EXPERIOR
 LOGISTICS
 FACILITY

1001 West Irving Park Road
 SCHAUMBURG, IL

FOR

EXPERIOR
 TRANSPORT

12161 SOUTH CENTRAL AVE.
 ALSIP, IL 60803



E9.0

PROJECT #: 18010
 DATE: 06/11/18
 REVISIONS: 01/17/22
 SCALE: AS NOTED

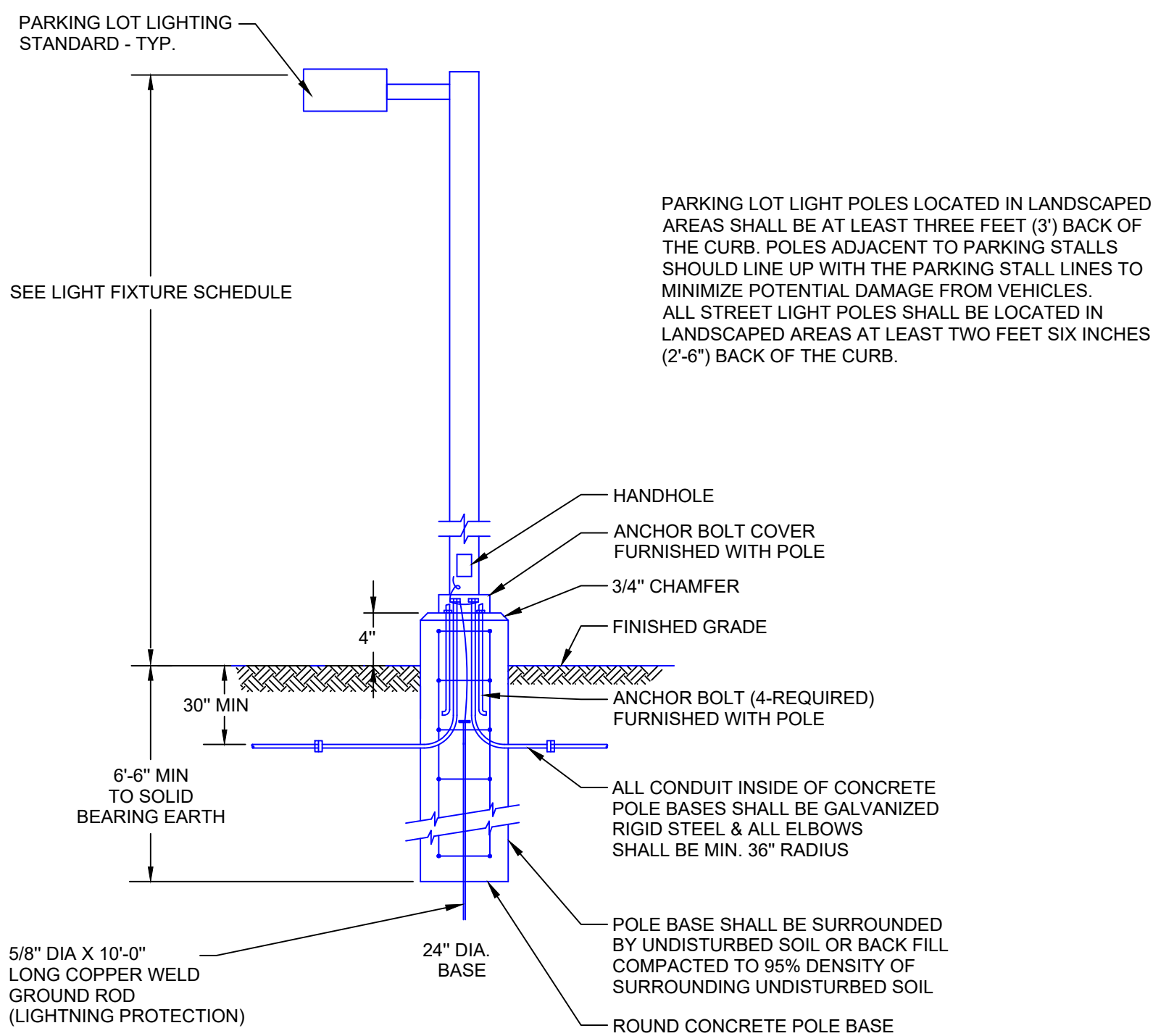

PARKING LOT LIGHT POLES LOCATED IN LANDSCAPED AREAS SHALL BE AT LEAST THREE FEET (3') BACK OF THE CURB. POLES ADJACENT TO PARKING STALLS SHOULD LINE UP WITH THE PARKING STALL LINES TO MINIMIZE POTENTIAL DAMAGE FROM VEHICLES. ALL STREET LIGHT POLES SHALL BE LOCATED IN LANDSCAPED AREAS AT LEAST TWO FEET SIX INCHES (2'-6") BACK OF THE CURB.

ROADWAY LIGHTING NOTES:
ALUMINUM LIGHT STANDARDS: POLES SHALL MEET OR EXCEED THE STRUCTURAL REQUIREMENTS OF AASHTO LRFD SPECIFICATIONS FOR STRUCTURAL SUPPORTS FOR HIGHWAY SIGNS, LUMINAIRES, AND TRAFFIC SIGNALS. LATEST EDITION. POLES SHALL CONFORM TO THE APPROVED DRAWINGS AND SPECIFICATIONS.

EACH POLE SHALL CONSIST OF A TAPERED ALUMINUM SHAFT HAVING A BASE WELDED TO THE LOWER END AND COMPLETE WITH ANCHOR BOLTS; AND A SINGLE ARM WITHOUT SCROLL AND POLE TOP. ALL CASTINGS SHALL BE CLEAN, SMOOTH, WITH ALL DETAILS WELL DEFINED AND TRUE TO PATTERN. ALL STRUCTURAL CASTINGS SHALL BE ALUMINUM ASSOCIATION ALLOY 356-T6. NONSTRUCTURAL CASTINGS SHALL BE ALLOY 43.

ALUMINUM POLE SIZES
NOMINAL MOUNTING HEIGHT "00"
MAST ARM SIZES 8, 10, 12, 15
POLE SIZE STREET 10" X 6" X 35/6"

ANCHOR BASE: A ONE-PIECE CAST ALUMINUM ANCHOR BASE OF ADEQUATE STRENGTH, SHAPE, SIZE AND HAVING A SCALLOPPED TOP FLANGE SHALL BE SECURED TO THE LOWER END OF THE SHAFT BY TWO (2) CONTINUOUS WELDS MADE BY THE METALLIC-ARC-CONSUMABLE-ELECTRODE-INERT-GAS-SHIELDED PROCESS. THE BASE SHALL TELESCOPE THE SHAFT. THE ONE (1) WELD SHALL BE ON THE INSIDE OF THE BASE AT THE END OF THE SHAFT, WHILE THE OTHER WELD SHALL BE ON THE OUTSIDE AT THE TOP OF THE BASE. THE TWO (2) WELDS SHALL BE NOT LESS THAN TWO INCHES (2") APART SO THAT THE WELDED CONNECTION SHALL DEVELOP THE DESIGN STRENGTH OF THE POLE ASSEMBLY. EACH BASE SHALL BE PROVIDED WITH FOUR (4) SLOTTED HOLES TO RECEIVE THE ANCHOR CARRIAGE BOLTS, FLAT WASHERS, AND LOCK WASHERS, AND FOUR (4) TAPPED HOLES FOR ATTACHING THE BOLT COVERS.

FOUR (4) REMOVABLE BOLT COVERS SHALL BE PROVIDED WITH EACH BASE AND EACH COVER SHALL ATTACH TO THE UP RIGHT PORTION OF THE BODY OF THE BASE BY MEANS OF ONE (1) STAINLESS STEEL HEX HEAD CAP SCREW. NYLON SCREWS ARE NOT ALLOWED.

A GROUNDING NUT FOR ACCOMMODATING A ONE-HALF-INCH (1/2") 13 UNC THREADED BOLT OR STUD SHALL BE PROVIDED ON THE INSIDE OF THE SHAFT IMMEDIATELY ABOVE THE BOTTOM WELD JOINING THE SHAFT TO THE ANCHOR BASE.

ANCHOR BOLTS: FOUR (4) HOT-DIPPED GALVANIZED STEEL CARRIAGE BOLTS, EACH FITTED WITH A HEX NUT, LOCK WASHER, AND FLAT WASHER SHALL BE FURNISHED WITH ALL POLES. EACH CARRIAGE BOLT SHALL BE SIZED WITH THE SQUARE NECK TO MATCH THE WIDTH OF THE SLOTTED BOLT CIRCLE. THE ANCHOR BOLTS SHALL BE CAPABLE OF RESISTING AT YIELD STRENGTH STRESS THE BENDING MOVEMENT OF THE SHAFT AT ITS YIELD STRENGTH STRESS.

BREAKAWAY DEVICE: THE ALUMINUM TRANSFORMER BASE SHALL BE APPROXIMATELY NINE INCHES (9") HIGH, FIFTEEN AND THREE-EIGHTHS INCHES (15 3/8") SQUARE AT THE BASE AND FOURTEEN AND THREE-FOURTHS INCHES (14 3/4") SQUARE AT THE TOP FOR A FIFTEEN-INCH BOLT CIRCLE. IT SHALL BE APPROXIMATELY NINE INCHES (9") HIGH, TWELVE AND THREE-FOURTHS INCHES (12 3/4") SQUARE AT THE BASE AND TWELVE AND ONE-FOURTH INCHES (12 1/4") SQUARE AT THE TOP FOR AN ELEVEN AND ONE-HALF-INCH (11 1/2") BOLT CIRCLE. A DOOR OPENING SHALL BE PROVIDED ON ONE (1) SIDE OF THE BASE. THE DOOR SHALL BE SECURED IN PLACE BY A STAINLESS-STEEL LOCKING SCREW. EACH BASE SHALL BE PROVIDED WITH FOUR (4) HOT-DIPPED GALVANIZED STEEL CARRIAGE BOLTS, EACH FITTED WITH A HEX NUT, LOCK WASHER, AND FLAT WASHER. FASTEN THE BRESS TO THE METAL FOUNDATION. EACH CARRIAGE BOLT SHALL BE SIZED WITH THE SQUARE NECK TO MATCH THE WIDTH OF THE SLOTTED BOLT CIRCLE.

A ONE-HALF-INCH (1/2") 13 UNC TAPPED HOLE SHALL BE PROVIDED FOR THE GROUNDING LUG. THE TRANSFORMER BASE SHALL HAVE A FINISH TO MATCH THE LIGHT POLES. IF THE TRANSFORMER BASE IS PAINTED, IT SHALL BE POWDER-COATED POLYESTER PAINT. THE PAINT SHALL BE REMOVED AT THE POINT OF CONNECTION FOR THE GROUND WIRE.

SHAFT: THE SHAFT SHALL BE SPUN FROM ONE (1) PIECE OF SEAMLESS TUBING, ALUMINUM ASSOCIATION ALLOY 6063, HAVING DIAMETERS AND WALL THICKNESSES AS INDICATED ON ENGINEERING DRAWINGS.

PARKING LOT AND STREET LIGHT BASE DETAIL

SCALE: NTS

NOTE INSTALLING CONTRACTOR SHALL BE RESPONSIBLE FOR THE FOLLOWING:
THE POLE BASE TO BE INSTALLED SHALL BE DESIGNED AND APPROVED BY A LICENSED STRUCTURAL ENGINEER IN THE STATE OF ILLINOIS. (EFFECTIVE PROJECTED AREA, EPA WIND LOADING REQUIREMENTS TO BE DETERMINED. FOR FINAL BASE SIZE)

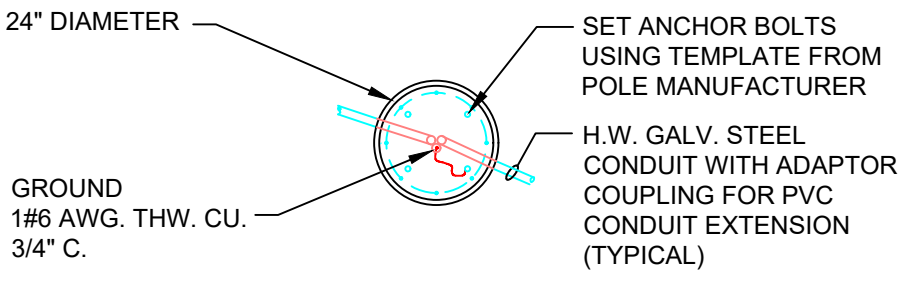

TOP VIEW OF PARKING LOT AND STREET LIGHT BASE WITH COVER PLATE REMOVED

SCALE: NTS

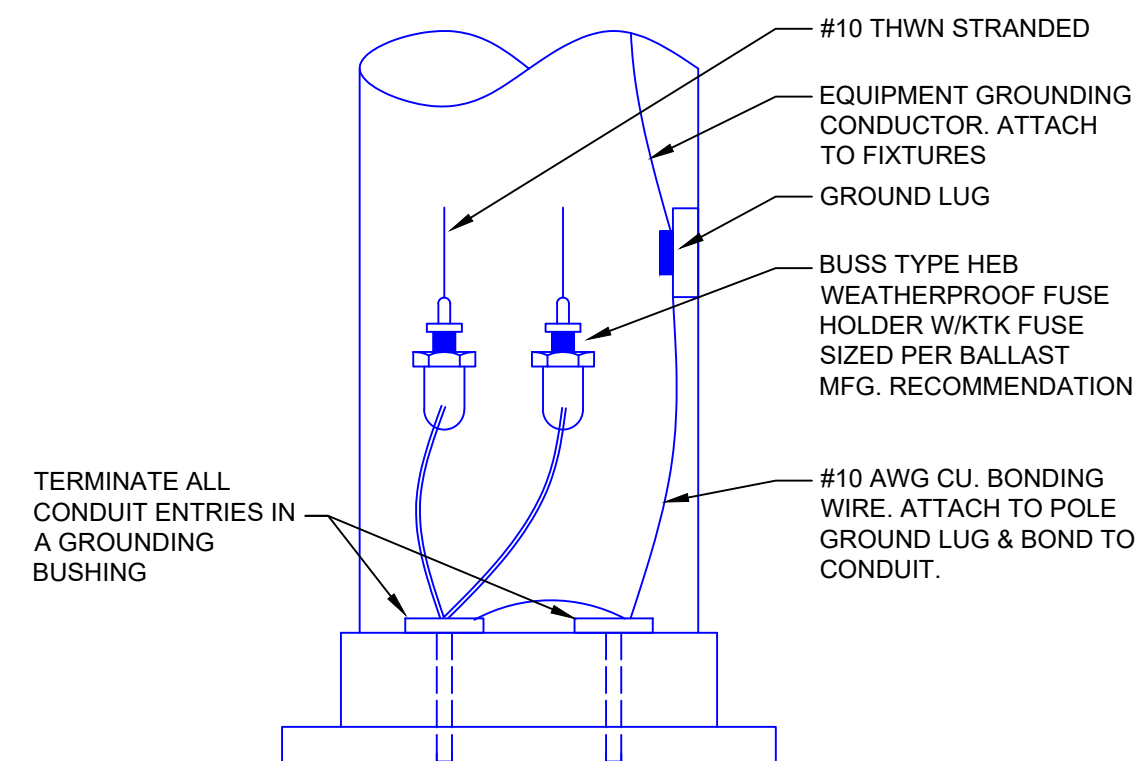

PARKING LOT AND STREET LIGHT WIRING DETAIL

SCALE: NTS



Gardco PureForm LED area medium P26 features a sleek, low profile design and optimal performance. PureForm area medium is designed to achieve maximum pole spacing, with lumen output up to 28,900 lumens. Multiple distribution and shielding options are available to achieve maximum control. A full range of control options provides additional energy savings.

Ordering guide example: P26-64L-800-NW-02-AR-3-120-HS-MGY

Part	Part Description	Order Code	Order Code	Order Code	Order Code	Order Code	Order Code
P26	PureForm area medium, 2'	64L 48 LED	800 800w	NW-02 70CR Generation 2	AR Arm Mount	02 2-30' Roadside Light 27V	3-120 120-277V
Options	Material	Finish	Control	Distribution	Shielding	Voltage	Finish

1. Extended lead times apply. Contact factory for details.
2. Mounting to a 4" round pole with adapter included in fixture price.
3. Limited to a maximum of 48 degrees aiming above horizontal.
4. Not available with other aiming control options.
5. Not available with motion sensor.
6. Not available with photo sensor.
7. Available only in 120 or 277V.
8. Not available in 347 or 480V.
9. Most specify input voltage.
10. Dimming will be connected to 0-10V dimming system.
11. Not available with other aiming control options.
12. Not available with other distribution options.
13. Not available with 0-10V dimming control system.
14. Not available with 0-10V dimming control system.
15. Not available with 0-10V dimming control system.
16. Not available with 0-10V dimming control system.
17. Most specify a motion sensor lens.
18. Not available with 0-10V dimming control system.
19. Not available with 0-10V dimming control system.
20. Not available with 0-10V dimming control system.

WALL MOUNTED LIGHTS FIXTURE TYPE W-T4 & WA-T4

SCALE: NTS

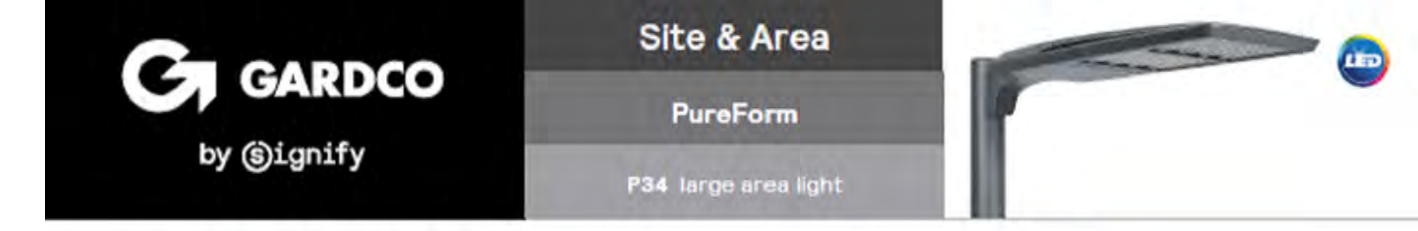

Gardco PureForm LED area large P34 features a sleek, low profile design and optimal performance. PureForm area large is designed to achieve maximum pole spacing, with lumen output up to 50,000 lumens. Multiple distribution and shielding options are available to achieve maximum control. A full range of control options provides additional energy savings.

Ordering guide example: P34-96L-800-NW-02-AR-5-120-F1-MGY

Part	Part Description	Order Code	Order Code	Order Code	Order Code	Order Code	Order Code
P34	PureForm area large, 12'	96L 96 LED	800 800w	NW-02 70CR Generation 2	AR Arm Mount	02 2-30' Roadside Light 27V	5-120 120-277V
Options	Material	Finish	Control	Distribution	Shielding	Voltage	Finish

1. Extended lead times apply. Contact factory for details.
2. Mounting to a 4" round pole with adapter included in fixture price.
3. Limited to a maximum of 48 degrees aiming above horizontal.
4. Not available with other aiming control options.
5. Not available with motion sensor.
6. Not available with photo sensor.
7. Available only in 120 or 277V.
8. Not available in 347 or 480V.
9. Most specify input voltage.
10. Dimming will be connected to 0-10V dimming system.
11. Not available with other aiming control options.
12. Not available with other distribution options.
13. Not available with 0-10V dimming control system.
14. Not available with 0-10V dimming control system.
15. Not available with 0-10V dimming control system.
16. Not available with 0-10V dimming control system.
17. Most specify a motion sensor lens.
18. Not available with 0-10V dimming control system.
19. Not available with 0-10V dimming control system.
20. Not available with 0-10V dimming control system.

PARKING LOT LIGHTS FIXTURE TYPE P-T3-HS, P-T4, P-T4-HS, P-T5-HS, & P-T5-2

SCALE: NTS

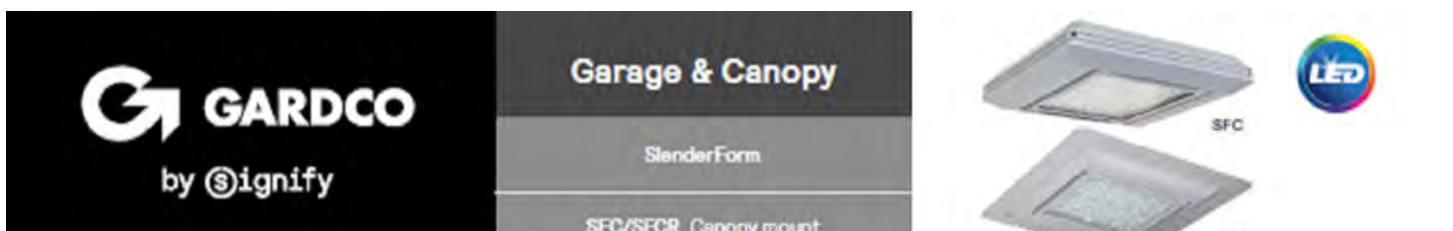

Gardco SlenderForm SFC/SFCR garage and canopy luminaire features high output LEDs and a sleek, yet powerful, low profile design. The thin 3" profile combined with LED high output performance make SlenderForm the ideal choice for exterior ceiling mount and canopy applications. SlenderForm luminaires also provide LED solutions for parking garage applications requiring higher light levels, including entrances, and for garage areas with high ceilings.

Ordering guide example: SFC-00-SW-48L-700-NW-02-UNV-MGY

Part	Part Description	Order Code	Order Code	Order Code	Order Code	Order Code	Order Code
SFC	SlenderForm ceiling luminaire	48L 48 LED	700 700w	NW-02 70CR Generation 2	SW Standard Luminaire	02 2-30' Roadside Light 27V	UNV 120-277V
Options	Material	Finish	Control	Distribution	Shielding	Voltage	Finish

1. SFCR recessed mount NOT available with 3000K.
2. Luminaire includes 0-10V input wires for dimming controlled by existing control system.
3. Only available in 120 through 277V.
4. Most specify applicable specific input voltage, not available with 0-10V or 0-10V.
5. Not available with SFCR recessed mount.
6. Through to ceiling mount only 12" (20-40mm) minimum pendant length required. Pendant by others. Option to install in the field only.
7. For right and left-hand pendant mount. Pendants by others.
8. 0-10V dimming other standards. Choose only if controlled by others.
9. Consult factory to confirm whether specific accessories are AA-compliant.

LED Wattage and Lumen Values: Standard SFC & SFCR luminaires

Order Code	LED Output (lm)	LED Output (lm)	LED Output (lm)	LED Output (lm)	LED Output (lm)	LED Output (lm)	LED Output (lm)
SFC or SFCR-48L-400-W-02	48	250	4000	38	4636	121	4804
SFC or SFCR-48L-400-W-02	48	400	4000	60	4932	118	7182
SFC or SFCR-48L-400-W-02	48	550	4000	82	5923	114	8640
SFC or SFCR-48L-400-W-02	48	700	4000	104	6828	108	11670
SFC or SFCR-48L-400-W-02	48	850	4000	131	7428	101	14288
SFC or SFCR-48L-400-W-02	48	1000	4000	158	8028	94	16988

CANOPY LIGHTS FIXTURE TYPE C-T4

SCALE: NTS

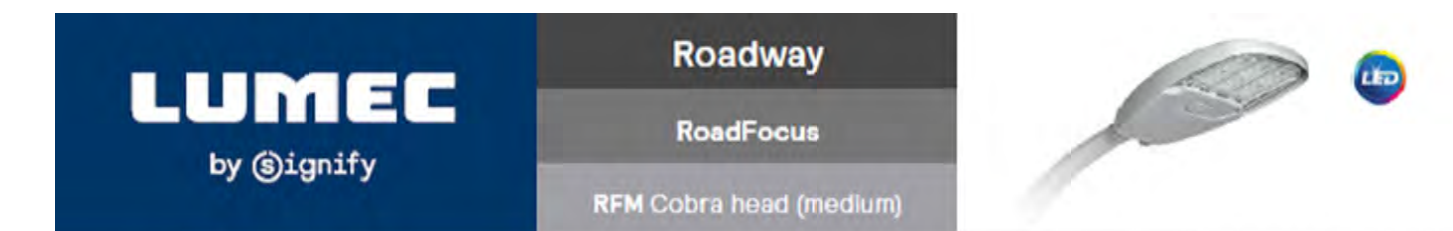

Lumec RoadFocus LED cobra head luminaires feature a sleek design that provides seamless replacement of existing HID luminaires. RoadFocus is available in three sizes, offers multiple lumen packages, and a complete array of optical distributions, making it an outstanding solution for all types of roadway applications. Includes Service Tag, innovative way to provide assistance throughout the life of the product.

Ordering guide example: RFM-100WELD-02-43M-UNV-010-HS-MGY-4000-02S

Series	LED module	CCT	Generation	Distribution	Voltage	Options	Options	Finish
RFM	100W LED	4K	02	02	UNV	02	02	02
Options	Material	Finish	Control	Distribution	Shielding	Voltage	Finish	Finish

1. Not available with MW.
2. Refer to accessories section to confirm compatibility or inquire with optical distributor.
3. Use of photo sensors, use of mounting legs to insure proper illumination.
4. Please refer to the integrated features column for details.
5. Please refer to the integrated features column for details.
6. Only available with SMO or SMO driver Options.
7. Only available with 0-10V dimming control system.
8. Only available with 0-10V dimming control system.
9. Only available with 0-10V dimming control system.
10. Only available with 0-10V dimming control system.
11. Only available with 0-10V dimming control system.
12. Only available with 0-10V dimming control system.
13. Only available with 0-10V dimming control system.
14. Only available with 0-10V dimming control system.
15. Only available with 0-10V dimming control system.
16. Only available with 0-10V dimming control system.
17. Only available with 0-10V dimming control system.
18. Only available with 0-10V dimming control system.
19. Only available with 0-10V dimming control system.
20. Only available with 0-10V dimming control system.

Accessories (Must be ordered as separate line item - quickly and easily installed in the field)

Description	Lumens	Accessory	Ordering Code	Ordering Code	Ordering Code	Ordering Code	Ordering Code
0-10V dimming	0-10V	0-10V	0-10V	0-10V	0-10V	0-10V	0-10V
Photo sensor	Photo	Photo	Photo	Photo	Photo	Photo	Photo
Motion sensor	Motion	Motion	Motion	Motion	Motion	Motion	Motion
0-10V dimming	0-10V	0-10V	0-10V	0-10V	0-10V	0-10V	0-10V

ROADWAY LIGHTS FIXTURE TYPE R-T2-HS

SCALE: NTS

arete design studio
architecture • planning • design
13543 West 18th Street, Mokena, Illinois 60448
815.465.7333

CIVIL ENGINEER:



LANDSCAPE ARCHITECT:



WETLAND CONSULTANT:



GARY R. WEBER ASSOCIATES, INC.

LAND PLANNING ECOLOGICAL CONSULTING LANDSCAPE ARCHITECTURE

402 W. LIBERTY DRIVE WHEATON, ILLINOIS 60187 PH: 630-668-7197

ELECTRICAL LIGHT FIXTURES

EXPERIOR LOGISTICS FACILITY

1001 West Irving Park Road, Schaumburg, IL

FOR

EXPERIOR TRANSPORT

12161 SOUTH CENTRAL AVE. ALSIP, IL 60803



E10.0

PROJECT #: 18010
DATE: 06/11/18
REVISIONS: 01/17/22
SCALE: AS NOTED

©COPYRIGHT 2022 arete design studio, ltd ALL RIGHTS RESERVED